

ON-WALL MOUNT

MODEL VTM6

APPLICATIONS
On-Wall
Magnetic Surfaces

DIMENSIONS (w x d x h)
9.7" x 0.9" x 7.5"
24.5 x 2.3 x 19.1 cm

FINISH
Silver - VTM6-S1

INCLUDES
MagFit™ iPad case
Mounts (2 pucks)
Hardware

Features a grippable
MagFit™ iPad case for fast
and secure attachment

Allows for easy viewing
at eye level; easily
adjusts for portrait or
landscape viewing



Includes two wall pucks
for installation in two
different rooms

Uses one included
screw to attach mount
to wood, concrete or
drywall surfaces

Designed to work with the
Apple® Smart Cover® to
ensure maximum iPad
protection and versatility



COMPATIBLE with iPad 2,
iPad 3rd Gen and iPad (4th Gen)



MODEL VTM16
APPLICATIONS
On-Wall
Magnetic Surfaces

FINISH
Silver - VTM16-S1

INCLUDES
MagFit™ iPad case
Mounts (2 pucks)
Hardware



COMPATIBLE iPad Mini



MAGFIT™ iPad® CASE & PUCKS

MODEL VTM7

APPLICATIONS
Magnetic Surfaces

DIMENSIONS (w x d x h)
9.7" x 0.6" x 7.5"
24.5 x 1.6 x 19.1 cm

FINISH
Clear - VTM7-X1
Black - VTM7-B1

INCLUDES
MagFit™ iPad case

Features exclusive MagFit™
technology for simple and secure
attachment to metal surfaces and
SANUS iPad mounting solutions

Constructed with durable
materials to protect your
iPad against everyday use

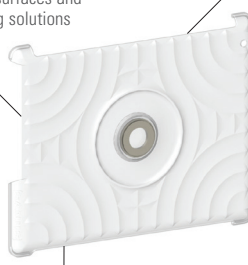

Unique back surface design
enhances the ability to
securely grip your iPad

Designed to work with the
Apple® Smart Cover® to
ensure maximum iPad
protection and versatility



COMPATIBLE with iPad 2,
iPad 3rd Gen and iPad (4th Gen)



MODEL VTM8
APPLICATIONS
On-Wall

FINISH
Silver - VTM8-S1

INCLUDES
2 puck mounts
Hardware



COMPATIBLE MagFit™ iPad and iPad Mini Case



NEW!



MODEL VTM27
APPLICATIONS
Magnetic Surfaces

INCLUDES
Black Air MagFit™ Case
FINISH
Black - VTM27-B1



COMPATIBLE iPad Air



www.sanus.com • info@sanus.com

©2014 Milestone AV Technologies. All Rights Reserved. SANUS is a division of Milestone. SANUS, and the SANUS logo are registered trademarks of Milestone. MagFit is a trademark of Milestone. Apple, the Apple logo, iPad and Smart Cover are registered trademarks of Apple Inc., registered in the US and other countries. Designed in USA.

SANUS®

DESK

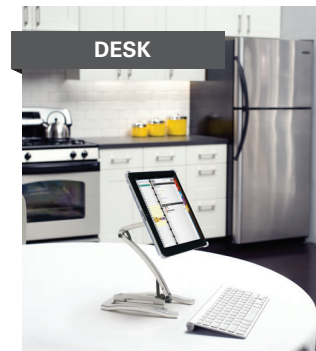

UNDER-CABINET



ON-WALL



MAGNETIC SURFACES



iPad® MOUNTS & STANDS

Clean, Simple Solutions For Your iPad, iPad Mini & iPad Air

Learn More



MODEL VTM6

iPad® MOUNTS

SANUS iPad products offer a broad range of applications – from a stand, to an under-the-cabinet mount, and an on-wall mount. Each product makes it easy to take your iPad on the go and features MagFit™ technology to ensure a secure connection on steel surface, like a refrigerator or metal cabinet. All mounts are compatible with the Apple® Smart Cover® to ensure maximum protection and versatility.

Brilliant Engineering

The Versatile **MagFit™** System



MagFit™ iPad Case connects to most metal surfaces

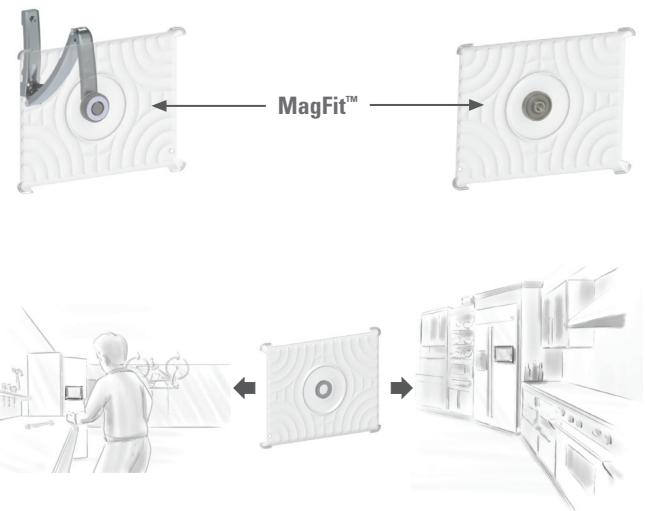

DESK STAND

MODEL VTM1	DIMENSIONS (w x d x h) 9.6" x 8.2" – 18" x 7.6" 24.5 x 20.8 – 45.7 x 19.3 cm	INCLUDES MagFit™ iPad case Mount Hardware
APPLICATIONS Desk Under-Cabinet On-Wall Magnetic Surfaces	FINISH Silver - VTM1-S1	

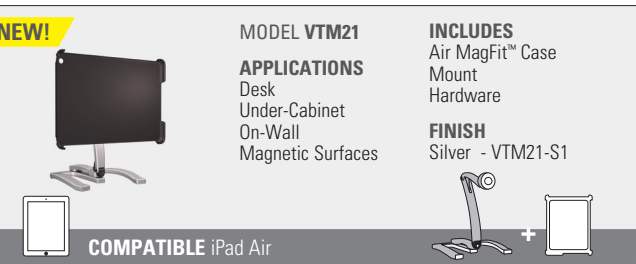
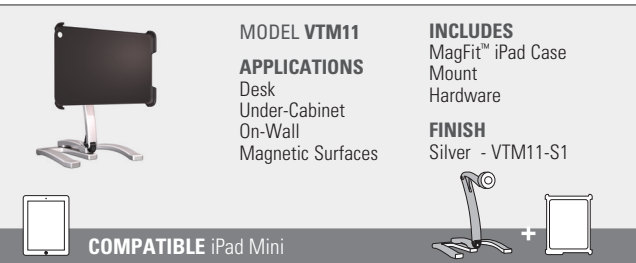
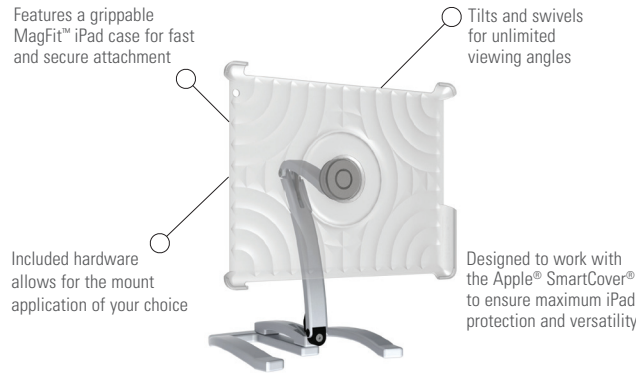

MODEL VTM21

UNDER-CABINET MOUNT

MODEL VTM5	DIMENSIONS (w x d x h) 9.7" x 10.1" – 17.1" x 7.3" 24.5 x 25.8 – 43.4 x 19.3 cm	INCLUDES MagFit™ iPad case Mount Hardware
APPLICATIONS Under-Cabinet On-Wall Magnetic Surfaces	FINISH Silver - VTM5-S1	

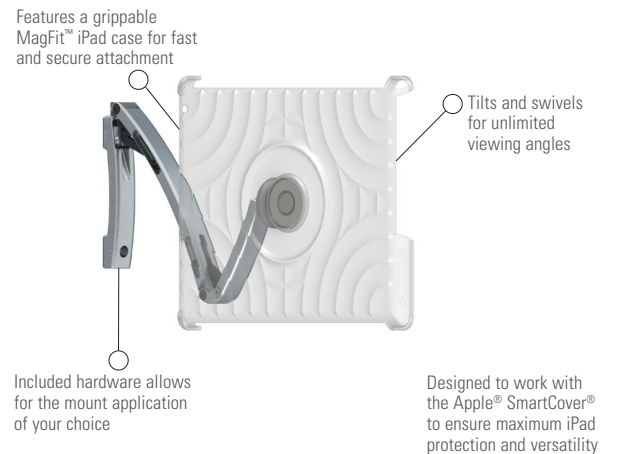

MODEL VTM5